

## With Custom Engraving

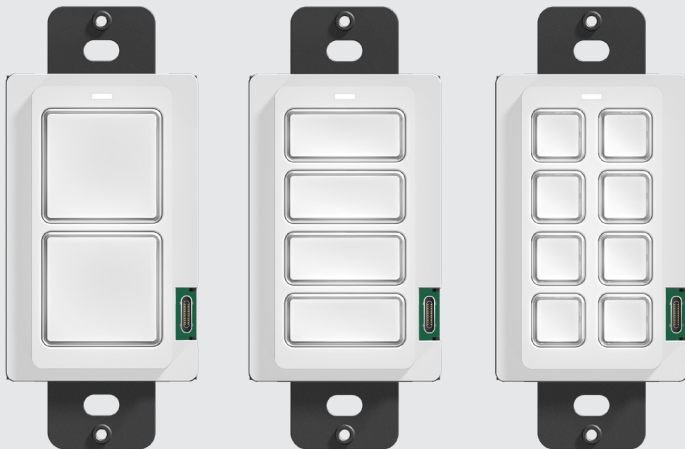

KP-2 / KP-4 / KP-8

with Decora® style wall plate (not included)



KP-2 / KP-4 / KP-8 in white

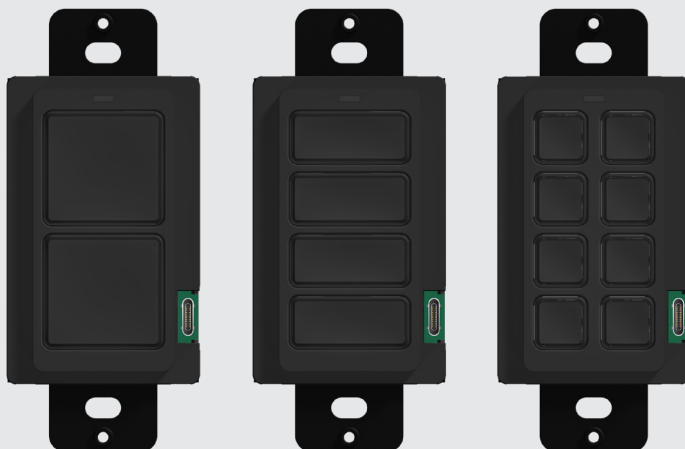

KP-2 / KP-4 / KP-8 in black

## KP-2 / KP-4 / KP-8 2/4/8 Button In-Wall Control Keypad

The KP keypad is the perfect addition to an RTI control system for fast and convenient control of music, lights, shades, and other devices or systems. Available with two, four, or eight fully programmable buttons, the KP keypad provides intuitive two-way feedback via configurable backlight colors for each button.

KP keypads ship with two sets of keypad faceplates and matching keycaps — one white and one black. For an elevated look and control experience, use RTI's Laser Shark™ engraving service to personalize the keycaps with custom text and graphics. These are available in White and Satin Black.

Compatible with Decora® style wall plates and sized to fit in a single gang US box, the KP keypads seamlessly integrate into homes and commercial buildings with a clean, intuitive on-wall control solution to match any decor.

For installation convenience, KP keypads are PoE powered, using the same network cable that runs control communication with the RTI processor.

## Key Features

- Two, four or eight assignable/programmable buttons.
- FREE Laser Engraving for custom text and graphics. A certificate for one free Laser Shark™ engraved keycap set included with purchase.
- Control communication and power over Ethernet (PoE).
- Ships with white keypad faceplate and keycap label kit, and a black keypad faceplate and keypad label.
- Backlight color is programmable on each button (16 colors available).
- Completely customizable and programmable.
- Fits in a single gang electrical outlet box.
- Network or USB Programming.
- Use any standard Decora® type wallplate (not included).

## Included in the Box

KP-2, KP-4, or KP-8 in-wall keypad controller, black and white faceplates (2), black and white keycap label kits (2), certificate for one Laser Shark engraved keycap set (1), captive screws (2)

## Specifications

Power .....	PoE IEEE802.3af
Backlights.....	RGB LED - 16 programmable colors
Control Port.....	10/100 BaseT with Power over Ethernet
System Memory.....	512K Bytes Flash (non-volatile) memory
Macro Capability.....	Macro capability on every button
Communications .....	USB Type C programming port
Enclosure .....	Formed Steel, black powder coat
Front Plate .....	High-impact molded ABS plastic
Mounting .....	US standard single-gang box
Decora® Type Front Plate* Dimensions (H x W) .....	4.6" x 2.75"
.....	(117 mm x 70 mm)
Dimensions (H x W x D).....	4.1" x 1.8" x 1.7"
.....	104 mm x 46 mm x 43 mm
Installation Cut-Out (H x W) .....	2.8" x 1.8"
.....	71 mm x 46 mm
Total Depth in Wall .....	1.37" (34mm) plus Cables
Operating Temperature .....	+32°F to +122°F (0°C to +50°C)
Operating Humidity .....	5% to 95% Non-condensing
Weight.....	4 oz (113 g)
Warranty.....	Three Years (Parts & Labor)

Specifications subject to change without notice.

Decora® is a registered trademark of Leviton Manufacturing Co. Inc.

\*Wallplate not included.

## Features



**Programmable Buttons**  
2, 4 or 8 buttons (depending on the model) provide quick access to control functions such as lights, shades, music, and audio/video source selection.



**In-Wall**  
The flush-mount keypad design enables easy control of frequent home or business activities.



**Ethernet**  
Use the existing standard home or corporate network infrastructure to connect the KP keypad to the RTI processor.



**PoE Powered**  
Use any PoE network switch to power the KP keypad over the same network cable that runs control communication with the RTI processor.



**2-Way with Control Status Feedback**  
Intuitive control is elevated with status feedback via the programmable button backlight colors.



**Ambient Light Sensor**  
Adjusts the backlight brightness automatically depending on the ambient light.



**Custom Engraved Keypad Buttons**  
For an elevated look and even more intuitive control experience, use RTI Laser Shark™ engraving service to customize the key caps with text and graphics.

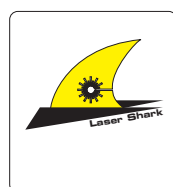
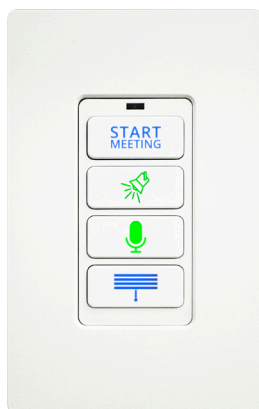

**CUSTOM ENGRAVING**  
The KP button keycaps may be custom laser etched using the RTI Laser Shark™ service. Each unit includes a certificate for one Laser Shark button order.

